



### General Description

VMD 2694TM is a center basket direct/indirect recessed luminaire offered in multiple sizes. It combines reflectors with a lens that controls the glare and delivers a unique light distribution. Designed for commercial and industrial building applications, it features a technical post-painted finish with 92% reflectance, reducing maintenance while also being durable and efficient.

### Features and Benefits

- Recessed installation.
- Post-painted in matte white finish with 92% reflectance.
- Formed and welded in 23-gauge steel (0.60mm).
- Standard sizes are 1ft x 4ft, 2ft x 2ft and 2ft x 4ft.
- Easy, tool-free removal of diffuser.
- Custom LED pattern holes available (contact Customer Service).

### Applications

Suitable for interior applications including hospitality, healthcare, education, retail, and office environments.

### Specifications

#### 1x4'

Length 47.7"

Width 12"

Height 3.4"

#### 2x2'

Length 23.73"

Width 23.74"

Height 3.4"

#### 2x4'

Length 47.7"

Width 23.69"

Height 3.4"

### Housing

23-gauge steel

### Finish

Post-painted matte white with minimum 92% reflectivity

*Please contact A.L.P. for pricing and delivery. A.L.P. will support design and development with customer supplied light engines. All specifications subject to change without notice. A.L.P. Lighting Components, Inc. assumes no responsibility for these materials in any luminaire or application. The product is an OEM component kit requiring final assembly by a qualified OEM fixture manufacturer.*

### Exploded View

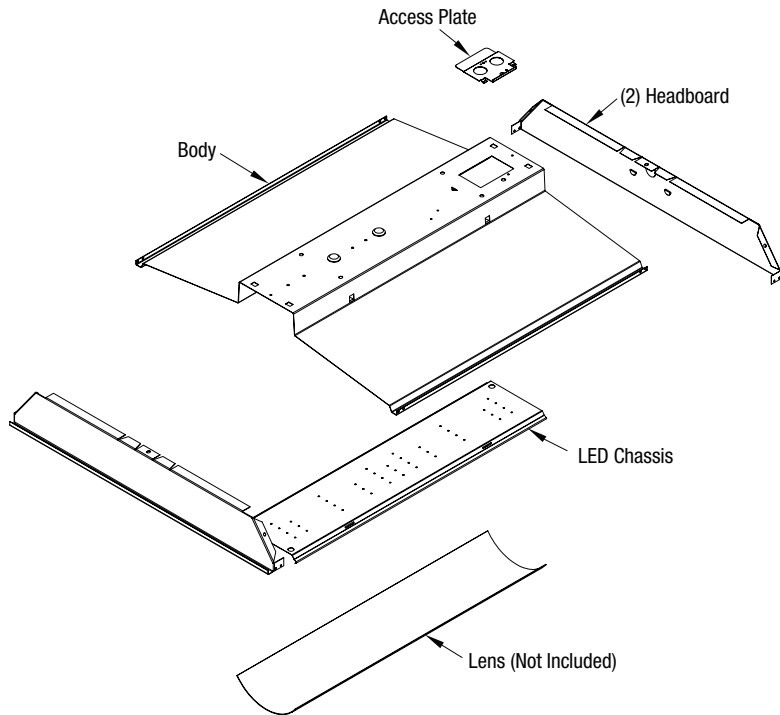

### Dimensions

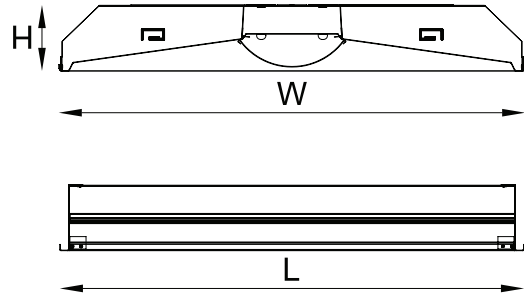

Model	Size	Length	Width	Height
VMD 2694TM	1x4	47.7	12	3.4
	2x2	23.73	23.74	3.4
	2x4	47.7	23.69	3.4

Please contact A.L.P. for pricing and delivery.

All specifications subject to change without notice. A.L.P. assumes no responsibility for these materials in any luminaire or application.

Kit Part No	Description	Part No	Qty	Qty/Plt
VMD 2694TM 1X4	Body	2694 1410	1	150
	Access Plate	510 15	1	
	End Plate	2694 1431	2	
	LED Gear Tray	2694TM 2406	1	
VMD 2694TM 2X2	Body	2694 2210	1	150
	Access Plate	510 15	1	
	End Plate	2694 2231	2	
	LED Gear Tray	2694TM 2206	1	
VMD 2694TM 2X4	Body	2694 2410	1	100
	Access Plate	510 15	1	
	End Plate	2694 2231	2	
	LED Gear Tray	2694TM 2406	1	