



2MTARS lens, FEW End Plug, and LPC latches shown.

Description

The Sentry[®] series is A.L.P.'s flagship Gasketed Enclosure. For general purpose and energy-efficient surface or suspended Fluorescent and LED enclosure, suitable for wet, damp, dusty and cold applications. Gear Tray choices of 1 and 2 rows include Tube types (fluorescent and LED) or use of LED linear boards attached to your choice of flat or angled gear trays. Truly a multi-purpose use enclosure for many solutions.

Applications

Ideal for use in dusty, dirty and/or wet environments including food processing, cold storage, kitchens, parking garages, car washes, covered canopies, pedestrian tunnels, concourse, industrial, and horticulture spaces.

For applications where the temperatures may exceed 80° C, A.L.P. recommends the use of stainless steel traylats. (i.e. three lamp/row fixtures)

Certifications

- UL/cUL recognized component
- Wet Location listed
- NSF - ANSI Standard 2

Features

- Rigid one-piece housing construction.
- Two ¼-28 brass studs molded into back of housing for attachment of optional mounting brackets.
- En-seal[™] gasketing provides superior resistance to moisture absorption versus conventional gasketing.
- Lens retained by four suitcase style latches.
- Molded latch pockets compatible with standard and tamper-proof latches in stainless steel and polycarbonate.
- Gear trays secured to #10-32 brass studs molded into housing via threaded hex steel mounting standoffs.
- Gear tray mounts to #10-32 brass stud molded into housing by two plastics or steel Traylats. for easy, tool-less removal.
- LED Module tray available for one and two rows of nominal 22" LED boards.
- Gear tray suspends from housing by two security straps during servicing.
- 2ft Sentry LED Parking Garage is in Parking Garage Compliance when the Sentry 2ft LED Angled Gear Tray (SENTGT2P38LED) is paired with the Sentry 2ft Parking Garage Reflector (SENTGT2P38REF).

Housing

Compression molded self-extinguishing fiberglass reinforced polyester compound with UL 5VA flame rating (ASTM D635-74) for gear tray types, and UL HB flame rating for strip types. F1 weatherability rating.

Gasketing

En-Seal[™] continuous perimeter poured gasket assures lens seal to housing.

Electrical Chassis

Gear Trays constructed of high reflective, 22-gauge, pre-painted steel.

Conduit Entry

Standard housings available with one 7/8" conduit entry point on either or both ends. Consult Sales for other opening sizes or for top openings.

Lens

Thermoformed lenses available in tapered or shallow profile in crepe pattern clear acrylic or frost acrylic.

Mounting

Standard stainless steel mounting brackets (BRKTS22PK) clip to housing for surface or all-thread pendant mounting. Consult sales for chain or cable mounting.

A.L.P. submitted this fixture for wet location testing in the horizontal surface mounted position. Any other operating position should be test verified by the OEM.

Please contact A.L.P. for pricing and delivery.

All specifications subject to change without notice. A.L.P. assumes no responsibility for these materials in any luminaire or application.

The product is an OEM component kit requiring final assembly by a qualified OEM fixture manufacturer.

Sealant required for wet location use.

EXPLODED VIEWS

2FT Sentry LED or Fluorescent (Gear Tray Type)

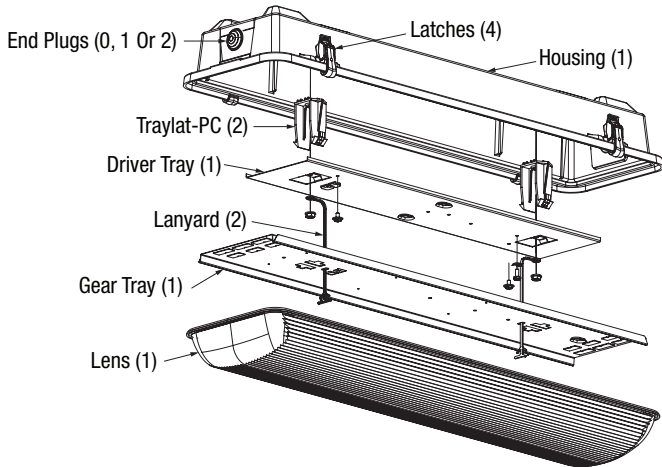

2FT Sentry LED Parking Garage

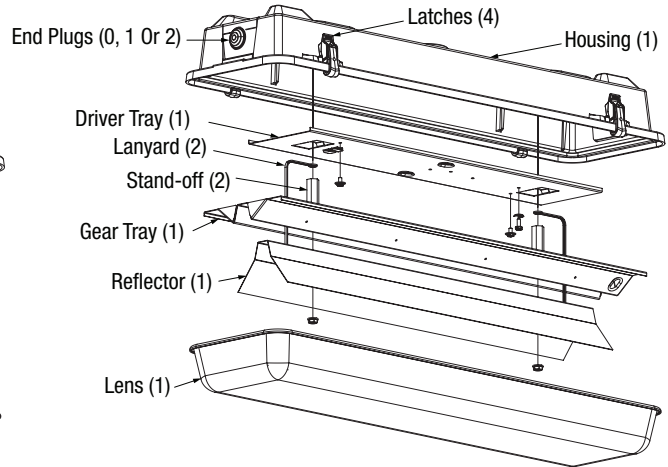

TOP VIEW

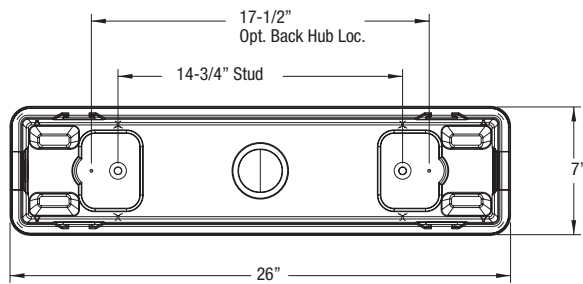

END VIEWS

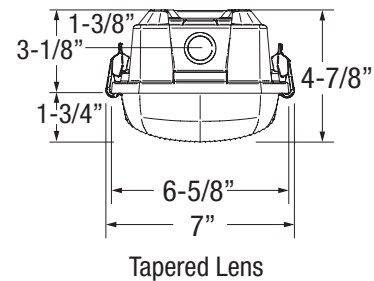

SIDE VIEW

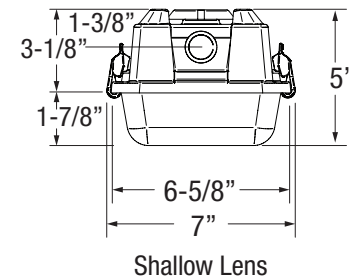
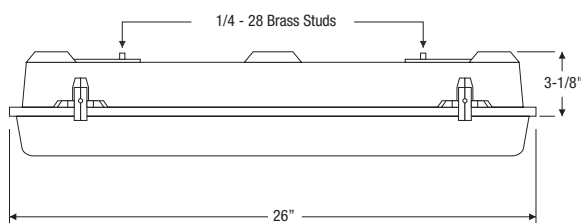

Note: Brass Studs on Inside of Unit are 10-32

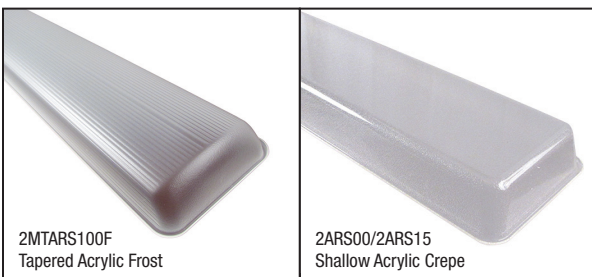

| HOUSING (Select One) | | |
|--|---|---|
| Part Number | Description (Requires 4 latches per housing) | Packaging |
| 2F-2-GTBS | 2ft LED & Fluorescent Gear Tray Type 5VA Housing (2 end holes) | 30 pcs carton; 120 pcs pallet |
| 2F-2 | 2' Sentry HB Housing 7/8" hole on both ends ³ | 30 pcs carton; 120 pcs pallet |
| LENS (Select one) | | |
| Part Number | Description | Packaging |
| 2MTARS100F | 2ft Tapered Lens, Acrylic 100% FROST | 30 pcs carton; 360 pcs pallet |
| 2ARS00 | 2ft Shallow Lens, Acrylic/Hi-IMPACT, Crepe pattern | 30 pcs carton; 360 pcs pallet |
| 2ARS15 | 2ft Shallow Lens, Acrylic/MED-IMPACT, Crepe pattern | 30 pcs carton; 360 pcs pallet |
| GEAR TRAY* (Select one) | | |
| Part Number | Description | Packaging |
| SENTRYGT2U | 2ft Fluorescent and LED Tube Flat Gear Tray, 2 Row | Bulk packaging |
| SENTRYGT2U-LED | 2ft LED Flat Gear Tray, 2 Row | Bulk packaging |
| SENTGT2P38LED | 2ft LED Angled LED, Parking Garage, 2 Row | Bulk packaging |
| CENTER REFLECTOR (Select one) | | |
| Part Number | Description | Packaging |
| SENTGT2P38REF | 2ft LED Parking Garage Reflector (to achieve Parking Garage compliance, use SENTGT2P38LED & SENTGT2P38REF together) | Bulk packaging |
| DRIVER TRAY* (Select one) | | |
| Part Number | Description | Packaging |
| SENTDT2-LED | 2ft LED Driver Tray - 2 Row | Bulk packaging |
| SENTDT2-SR | 2ft LED Driver Tray - 1 Row | Bulk packaging |
| LATCHES (Select one) | | |
| Part Number | Description (Requires 4 latches per housing) | Packaging |
| LPC | White polycarbonate latch | 30 pcs bag; 990 pcs carton. ⁴ |
| LPCTP3 | Tamper-proof white polycarbonate latch with nut and screw | 30 pcs bag; 990 pcs carton. ⁴ |
| LSS-3 | Stainless steel latch | 30 pcs bag; 480 pcs carton. ⁴ |
| LSS-3TP | Tamper-proof stainless steel latch with nut and screw | 30 pcs bag; 480 pcs carton. ⁴ |
| WIRE ENTRY PLUGS (Select none, one or two depending on housing selected) | | |
| Part Number | Description | Packaging |
| FEPW | White 7/8" dry location plug | 40 pcs bag; 5000 pcs carton. ⁴ |
| LTP088 ¹ | White 7/8" liquid tight plug | 30 pcs bag; 1800 pcs carton. ⁴ |
| DC-2S ¹ | 7/8" die cast aluminum fitting assembly for 1/2" rigid conduit | 30 pcs inner carton; 240 pcs carton. ⁴ |
| HOUSING MOUNTING BRACKET (Select one) | | |
| Part Number | Description | Packaging |
| BRKTS22PK | Sentry stainless steel strap bracket, 2-pack | 60 pcs bag; 4960 pcs carton. ⁴ |
| MISCELLANEOUS PARTS | | |
| Part Number | Description | Packaging |
| TRAYLAT-PC | White polycarbonate gear tray mounting clip (NUT1001 Required) | 60 pcs bag; 990 pcs carton. ⁴ |
| TRAYLATSS ² | Stainless steel gear tray mounting clip (NUT1001 Required) | 60 pcs bag; 960 pcs carton. ⁴ |
| 10-32MFSTANDOFF | Threaded hex steel mounting standoff for 1-row LED module gear tray | 120 pcs bag. ⁴ |
| LANYARD | White nylon security strap | 30 pcs bag; 4800 pcs carton. ⁴ |
| HARDWARE ⁵ | | |
| Part Number | Description | Packaging |
| NUT1001 | #10-32x3/8" steel hex locking nut for TRAYLAT attachment to housing | 5000 pcs carton |
| TAMPER BIT 3 | Driver bit for TAMPERPRUF screw used in LPCTP3 & LSS-3TP | |
| TAMPER BIT 8 | Driver bit for tamper-proof snake eye drive screw, compatible with LSS-3 | |

1. Sealant required for wet location use.
2. A.L.P. recommends using TRAYLATSS for three lamp fixtures.
3. HB rated material are not acceptable for use as an electrical enclosure, they require an internal metal enclosure "strip fixture".
4. Orders must be ordered in bag or carton qty's.
5. If hardware is purchased through ALP the MOQ will be based on the outsourced vendor MOQ's
6. For custom hole/feature patterns, supply Order Sheet to BBS or Customer Service Representative.

GEAR TRAYS

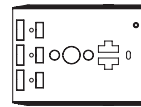

SENTRYGT2U



SENTRYGT2U-LED

LATCHES

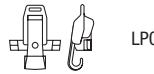

LPC

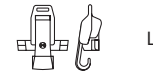

LPCTP3

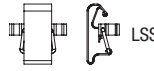

LSS-3

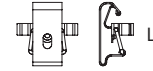

LSS-3TP

WIRE ENTRY PLUGS



FEPW



LTP088¹



DC-2S¹

LENSES

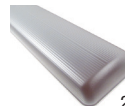

2MTARS100F



2MTARSMI



2ARS15/2ARS00

HOUSING MOUNTING BRACKETS



BRKTS22PK

MISCELLANEOUS PARTS



TRAYLATSS²

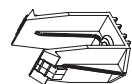

TRAYLAT-PC



LANYARD

HARDWARE

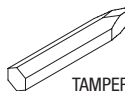

TAMPER BIT 8



TAMPER BIT 3