

REV/EDCO	DESCRIPTION	DATE	APPROVED
A	INITIAL RELEASE	10-30-2017	RCOII
B	ADDED MOON GLOW TO MATERIAL OPTIONS	2-11-2019	RCOII

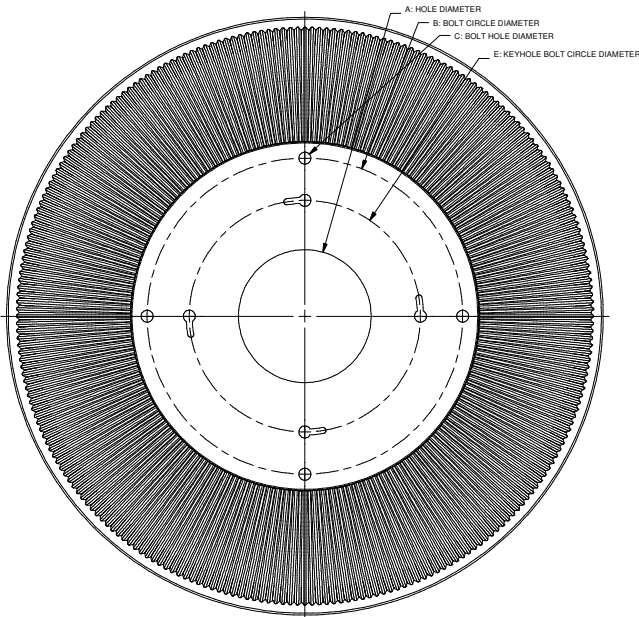

CUSTOM CUT MAX FEATURE DIM 6.10"		
ITEM	DESCRIPTION	VALUE
A	HOLE DIA.	
B	BOLT CIRCLE DIA.	
C	HOLE DIA.	
D	# OF HOLES ON BOLT CIRCLE EQ. SPACED	
E	KEYHOLE BOLT CIRCLE DIAMETER	
F	LARGE KEYHOLE DIA.	
G	ARC LENGTH OR ANGLE	
H	SMALL KEYHOLE DIA.	
I	# OF KEYHOLES ON KEYHOLE BOLT CIRCLE EQ. SPACED	
CUSTOM SEE ATTACHED DWG COMPANY NAME		LIST DWG NAME AND REVISION
NAME		YOUR COMPANY NAME
SIGNATURE		NAME OF PERSON FILLING OUT FORM
DATE		AUTHORIZED SIGNATURE
		DATE COMPLETED

OPTIONS	METALIZING	
	YES	NO
WHITE POLYCARBONATE ONLY		

OPTIONS	MATERIAL	
	YES	NO
AC		
MOON GLOW		
PC		
LUMEO		
INTERFACE		

**NOTES:**

- UNLESS OTHERWISE NOTED; ALL DIMS. ARE INCHES
- TOLERANCES: .xxx ± 0.032
- PLEASE COMPLETE SUPPLIED TABLE FOR CUSTOM CUT TOPS.
- FEATURES SMALLER THAN Ø0.130" WILL REQUIRE LASER CUTTING.
- IF NEEDS FALL OUTSIDE SUPPLIED TABLE PLEASE PROVIDE DRAWING.
- A.L.P. LIGHTING COMPONENTS INC. RECOMMENDS A LOAD BEARING COLLAR OR WASHER BE USED AROUND FASTENERS

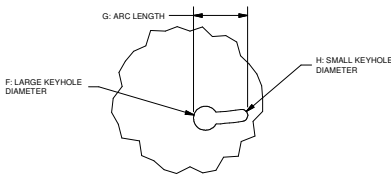

A.L.P.

LexaLite

REVISIONS: MATERIAL: N/A FINISH: N/A COLOR: N/A HOLE: N/A ARC: N/A DRIVING TOLERANCE:	DRAWN BY: RCOII DATE: 10/27/2017 CHECKED BY: RDTII DATE: 10/30/2017
MODEL FILENAME: S12 Ordersheet.pt	TOLERANCES UNLESS SPECIFIED: FRACTION DECIMALS ANGLES .00 .03 .015 .005 .5
NOTICE: THIS DRAWING AND THE INFORMATION IT DISCLOSES IS THE EXCLUSIVE PROPERTY OF A.L.P. INC. ANY REPRODUCTION OR USE OF THIS DRAWING IN WHOLE OR IN PART, WITHOUT THE EXPRESS CONSENT OF THE PROPRIETOR, IS PROHIBITED.	S12 ORDER SHEET SHEET 1 OF 1 S12 ORDERSHEET